

---

*Comfort-Aire*®

**Century**®



---

REPLACEMENT PARTS LIST

**Low Temperature Mini-Split  
Indoor Ducted Unit**

B-VMH24DU-1

# EXPLODED VIEW

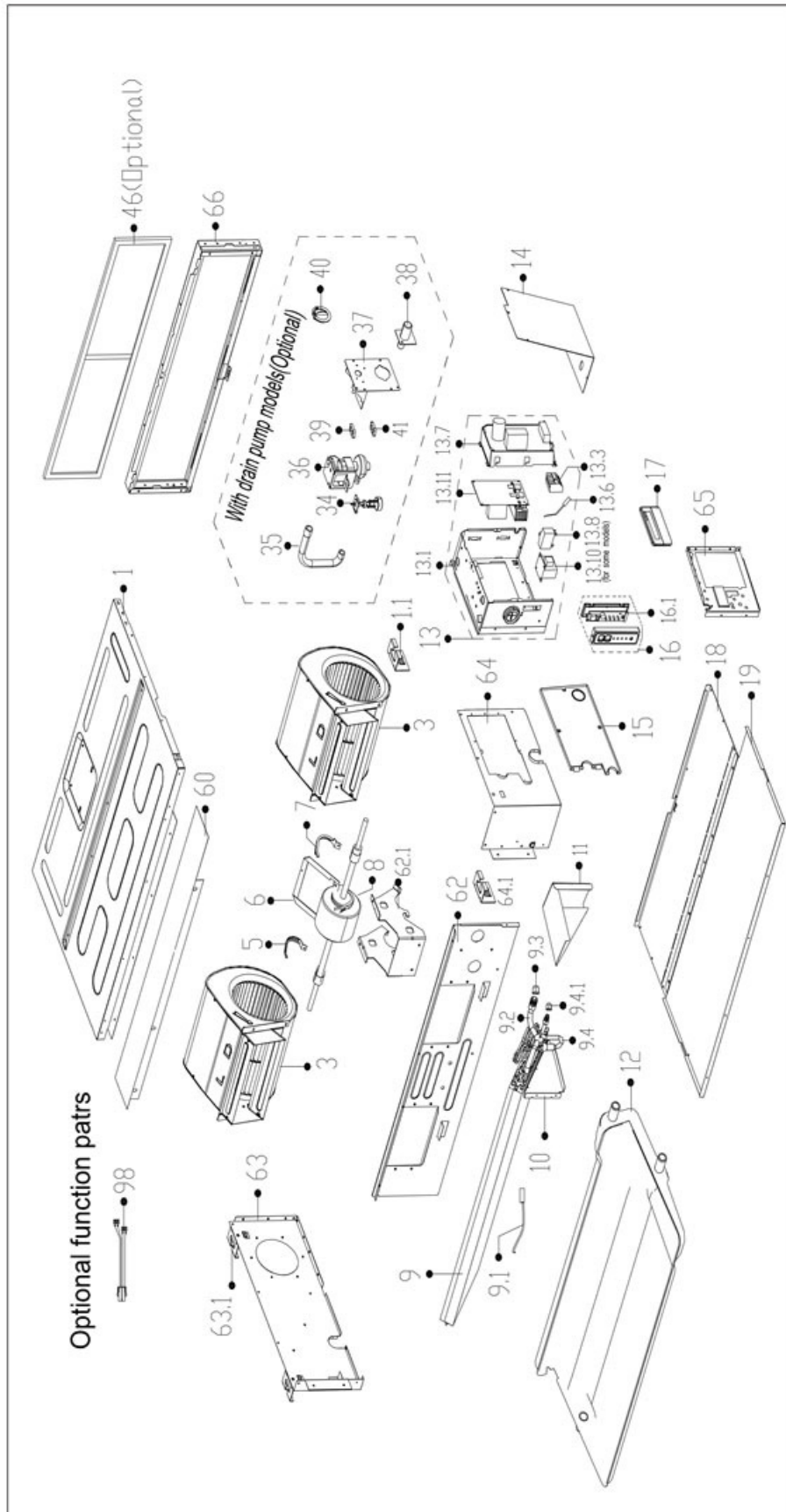

## REPLACEMENT PARTS

Location	Part Name	Quantity	Part No.
1	Chassis subassembly	1	12223000008889
3	centrifuge fan assembly	2	12200101000194
5	Fan motor clamp (left)	1	12222500000253
6	Fan motor fixing bracket	1	12223000000537
7	Fan motor clamp (right)	1	12222500000255
8	Brushless DC Motor	1	11002015002521
9	Evaporator Assembly	1	15823000002685
9.1	Pipe Temperature Sensor	1	11201007000136
9.2	Evaporator outlet pipe subassembly	1	15123000008702
9.3	Copper nut	1	15500406000003
9.4	Evaporator inlet pipe subassembly	1	15123000009029
10	Evaporator right support board subassembly	1	12223000008851
11	Water collector subassembly	1	12223000008848
12	Water collector assembly	1	12223000008876
13	E-Parts Box assembly	1	17223000004417
13.1	Electronic control box	1	12223000006638
13.3	Wire joint	1	17400401000075
13.6	Room Temperature Sensor	1	11201007000283
13.7	Main control board subassembly	1	17123000003474
13.10	Reactor	1	17400306000070
13.11	Inverter module subassembly	1	17122000030569
14	Cover of electronic control box subassembly	1	12223000009109
15	Pipe clamp board subassembly	1	12223000008849
16	Duct display board subassembly	1	17223000000003
16.1	Duct display board subassembly	1	17123000002712
17	Wired controller	1	17317100001195
18	Rear cover subassembly	1	12223000008888
19	Top cover subassembly	1	12223000008887
46	Air filter	1	12123000A00300
60	Front beam subassembly	1	12223000008890
62	Middle beam subassembly	1	12223000008875
63	Left clapboard subassembly	1	12223000008850
64	Right clapboard subassembly	1	12223000008853
65	Right side plate	1	12223000008114
66	Right clapboard subassembly	1	12223000A03124

---

Due to ongoing product improvements, specifications and dimensions are subject to change and correction without notice or incurring obligations. Determining the application and suitability for use of any product is the responsibility of the installer. Additionally, the installer is responsible for verifying dimensional data on the actual product prior to beginning any installation preparations.

Incentive and rebate programs have precise requirements as to product performance and certification. All products meet applicable regulations in effect on date of manufacture; however, certifications are not necessarily granted for the life of a product. Therefore, it is the responsibility of the applicant to determine whether a specific model qualifies for these incentive/rebate programs.

*Comfort-Cire*®  **Century**®

1900 Wellworth Ave., Jackson, MI 49203 • Ph. 517-787-2100 • [www.marsdelivers.com](http://www.marsdelivers.com)

